



# WireLessFlexBrowser

## Configuration

wfb\_configuration\_en.doc

20070213 Version 6.0 En	
20070605 Version 7.0 En	

## Configuration

Abstract.

*WireLess FlexBrowser* configuration can be updated from the menu options (in the PDA, volatile) and from a .cfg file, as well, that the application will load into the Windows Registry. This file is generated externally and can be transferred to the device through ActiveSync or using the component *Web Downloader* (in the PC, non volatile).

The first option on the terminal installation procedure proposes customized configuration of the application through Inieditor (“Personalize WireLess FlexBrowser”). When closing IniEditor, if the configuration has been modified, a message will appear asking if you want to save the changes. These changes will be saved on the .cfg file.

By clicking on the “*Load Config*” button, the configuration file will be saved on the terminal root folder. If `_flexbrowser.cfg` is loaded on the root folder, *WireLess FlexBrowser* will read the information and move the file to a flash folder in order for the configuration to remain **persistent**.

*Web Downloader* works on HTTP and is capable of downloading a set of files. One of them is the one called `_dnlce.cfg`, which contains the names of the files to be downloaded, as well as the path where the application returns to, when the *Downloader* exits.

One of the files whose name could be placed into `_dnlce.cfg` is `_flexbrowser.cfg`. If this file was downloaded into the root folder of the device, *WireLess FlexBrowser* would load all the entries of this file into the registry, and afterwards delete the file.

If `_flexbrowser.cfg` is downloaded into a flash folder and a file called `wfb_readcfg.txt` (with any content) is downloaded to the “\Windows” folder, then the application loads all the configuration file entries to the Windows Registry. The configuration file is not deleted, but `wfb_readcfg.txt` is.

Due to the fact that *WireLess FlexBrowser* exits when it calls *Web Downloader* application, it is also possible to upgrade the version of *WireLess FlexBrowser* stating the executable file as one of the files to download.

### Structure of `_dnlce.cfg`

The first line is always the same. The second one indicates the version number. For each line, the double character “%%” indicates that all of the following is a commentary and will ignored by the *Downloader*. There are two sections. The name of the section is placed between square brackets. All the lines between two section

names, or the ones beyond the last section name, are considered as part of the section that corresponds to the last section name statement.

All the lines of a section share the same syntax:

```
Key = Value
```

One of the sections must be [DOWNLOADS]. This section contains a key "Number" whose value is the number of files to download. Keys of the form "FileXX" must follow it, where XX (2 digits) goes from 01 to the number specified by the key "Number".

The structure of the "FileXX" key is:

```
File<XX>=[relative_url]source_file[, [absolute_path]destination_file]
```

*relative\_url*: relative to the download page to which *Web Downloader* is connected. If *relative\_url* is absent, *Downloader* assumes it is the main page that it is connected to.

*source\_file* (mandatory): name of the file to be downloaded.

*absolute\_path*: the path where the file is downloaded to. If absent, *Web Downloader* assumes it is the root folder (\) on the device.

*destination\_file*: name that *Web Downloader* will use to store the downloaded file. If absent, the original name will be used.

An optional section called [RETURN] can be placed. It consists of only one key "To" with the absolute path of the executable, which will be called on return. *WireLess FlexBrowser* sets itself as the application to return to, from *Downloader*. So, if this file doesn't contain this section, *Downloader* will return to *WireLess FlexBrowser* by default.

Example:

```
%%FILE=_dnlce.cfg%%

%% dnlce associated files for download
[DOWNLOADS]
Number=4
File01= _flexbrowser.cfg
File02= wfb/wfb.ex_      , \windows\wfb.exe
File03= wfb/zip.dll_    , \zip.dll
File04= wfb/unzip.dll_  , unzip.dll

[RETURN]
To= \Windows\wfb.exe
```

If *\_dnlce.cfg* is hosted and accessible through [http://my\\_site/dnl](http://my_site/dnl), and *Web Downloader* is configured to connect to this url, it will download the next files:

```
http://my_site/dnl/_flexbrowser.cfg to \_flexbrowser.cfg
http://my_site/dnl/wfb/wfb.ex_ to \ windows\wfb.exe
http://my_site/dnl/wfb/zip.dll_ to \ zip.dll
http://my_site/dnl/wfb/unzip.dll_ to \ unzip.dll
```

and it will return to the downloaded (upgraded) version of wfb.exe.

## Structure of \_ flexbrowser.cfg

This file is intended to configure all of the settings likely of being configured in the device. The first line is always the same. The second one indicates the version number. For each line, the double character “%%” indicates that all of the following is a commentary and will be ignored by the client. All the lines of a section share the same syntax:

Key = Value

Before processing keys and values, blank characters are removed, so it doesn't matter if leading and trailing spaces and tabs are used for arranging data in columns. Values can be avoided, indicating that the value is empty.

There are several sections. The name of the section is placed between square brackets. All the lines between two section names, or the ones beyond the last section name, are considered as part of the section that corresponds to the immediate previous section name statement. The structure of section statements and key-values can be considered as a one-to-one relationship with the one that is on the registry. All sections that are not in the registry will be added.

An example containing the settings used by the clients up to date is shown below.

```
%%FILE=_flexbrowser.cfg%%

%% Root section of the tree. It will be stored into:
%% HKEY_CURRENT_USER\Software\
%% 10 entries
[wfb]

%% URL for the current selected homepage.
Homepage = wfb.html

%% Display confirmation message when pressing
%% the HOME icon. Possible values: on/off.
HomepageConfirm = on

%% If HomepageConfirm is set to Yes, this will be the
%% message to be displayed.
HomepageConfirmText = Are you sure you want to go to
homepage?
```

```
%% Administrator's password
Password = lchdf566

%% Current use mode: user or administrator.
Mode = user

%% Select the application's language: Fr,Sp,En,Pt.
Language = En

%% Debugging modes: db, sync, qry, event, html, all, off.
Traque = off

%% Working Directory.
WorkingDir = \Windows

%% Generate trace files with the HTML source code of
%% received pages in <WorkingDir>\FB<nnnn>.htm where nnnn
%% is a sequence beginning with 0000. Possible values:
%% on/off.
SaveSource = off

%% When starting the application, it shows a dialog box
%% that indicates the keys of the new configuration that
%% is loading. Possible values: on/off.
ShowNewConfigDialog = on

%% 18 entries
%% This section configures the administrator mode options
[wfb\AdminOptions]

%% Show the 'Activate Keyboard' option in the
%% administrator mode menu. Possible Values: on/off.
ActivateKeyboard = on

%% Disable the 'Back' button in administrator mode.
%% Possible values: on/off.
DisableNavBack = off

%% Disable the 'Forward' button in administrator mode.
%% Possible values: on/off.
DisableNavForw = off

%% Disable the 'Refresh' button in administrator mode.
%% Possible values: on/off.
DisableNavRefr = off

%% Show the 'Keyboard Test' option in the administrator
%% mode menu. Possible values: on/off.
KbdTest = on
```

```
%% Show the 'Launch Process' option in administrator mode
%% menu (this option must be set on in order to have
%% access to the applications added on the "wfb/Process"
%% section). Possible values: on/off.
LaunchProcess = on

%% Enable the 'Load New Configuration' option in the
%% administrator mode menu. Possible values: on/off.
LoadNewConfig = on

%% Show the 'Activate Contextual Menu' option in the
%% administrator mode menu. Possible values: on/off.
OptionsActivateContextMenu = on

%% Show the 'Fit To Screen' option in the administrator
%% mode menu. Possible values: on/off.
OptionsFitToScreen = on

%% Show the 'Text Size' option in the administrator mode
%% menu. Possible values: on/off.
OptionsTextSize = on

%% Show the 'Quit' option in the administrator mode menu.
%% Possible values: on/off.
Quit = on

%% Show the 'Set Home Page' option in the administrator
%% mode menu. Possible values: on/off.
SetHomePage = on

%% Show the 'Back' button on the toolbar
%% in administrator mode. Possible values: on/off.
ToolbarNavBack = on

%% Show the 'Forward' button on the toolbar
%% in administrator mode. Possible values: on/off.
ToolbarNavForw = on

%% Show the 'Home' button on the toolbar
%% in administrator mode. Possible values: on/off.
ToolbarNavHome = on

%% Show the 'Refresh' button on the toolbar
%% in administrator mode. Possible values: on/off.
ToolbarNavRefr = on

%% Show the 'RF Status' icon on the toolbar
%% in administrator mode. Possible values: on/off.
ToolbarRadFreq = on

%% Show the 'Activate/Deactivate keyboard icon' on the
```

```
%% toolbar in administrator mode. Possible values: on or
%% off.
ToolbarKeyboard = off

%% 18 entries
%% This section configures the user mode options.
[wfb\UserOptions]

%% Show the 'Activate Keyboard' option on the user mode
%% menu. Possible values: on/off.
ActivateKeyboard = on

%% Disable the 'Back' button in user mode. Possible
%% values: on/off.
DisableNavBack = off

%% Disable the 'Forward' button in user mode. Possible
%% values: on/off.
DisableNavForw = off

%% Disable the 'Refresh' button in user mode. Possible
%% values: on/off.
DisableNavRefr = off

%% Show the 'Keyboard Test' option in the user mode menu.
%% Possible values: on/off.
KbdTest = on

%% Enable the 'Load New Configuration' option in the
%% user mode menu. Possible values: on/off.
LoadNewConfig = on

%% Show the option 'Launch Process' in user mode menu.
%% (this option must be set on in order to have
%% access to the applications added on the "wfb/Process"
%% section). Possible values: on/off.
LaunchProcess = off

%% Show the 'Activate Contextual Menu' option in the
%% user mode menu. Possible Values: on/off.
OptionsActivateContextMenu = off

%% Show the 'Fit To Screen' option in the user mode menu.
%% Possible values: on/off.
OptionsFitToScreen = off
```

```
%% Show the 'Text Size' option in the user mode menu.
%% Possible values: on/off.
OptionsTextSize = on

%% Show the 'Quit' option in the user mode menu.
%% Possible values: on/off.
Quit = on

%% Show the 'Set Home Page' option in the user mode menu.
%% Possible values: on/off.
SetHomePage = off

%% Show the 'Back' button on the toolbar in user mode.
%% Possible values: on/off.
ToolbarNavBack = off

%% Show the 'Forward' button on the toolbar in user mode.
%% Possible values: on/off.
ToolbarNavForw = off

%% Show the 'Home' button on the toolbar in user mode.
%% Possible values: on/off.
ToolbarNavHome = off

%% Show the 'Refresh' button on the toolbar in user mode.
%% Possible values: on/off.
ToolbarNavRefr = off

%% Show the 'RF Status' icon on the toolbar in user mode.
%% Possible values: on/off.
ToolbarRadFreq = off

%% Show the 'Activate/Deactivate keyboard icon' on the
%% toolbar in user mode. Possible values: on/off.
ToolbarKeyboard = off

%% 2 entries
%% This section configures the emulation mode.
[wfb\Emulation]

%% Activate the emulation Symbol Pocket Browser.
SymbolPB = on

%% Activate the emulation Intermec's iBrowse.
iBrowse = off

%% 2 entries
%% This section lists the possible URLs to select as
```

```
%% homepages using the 'Set Home Page' menu (see
%% 'SetHomePage' option).
[wfb\Hp]

%% URL of suggested homepages (you can add or delete
%% URLs).
Hp00 = http://ppc.softogo.com/fb/index.htm
Hp01 = http://www.raisonnance.fr

%% 3 entries
%% This section configures the keyboard options.
[wfb\Keyboard]

%% Writes only uppercase or downcase strings. Possible
%% values: toupper/todown/none.
AllUpperDown = none

%% Turns the SIP Panel on or off (virtual keyboard).
%% Possible values: on/off.
SipOn = on

%% List of system keys to ignore. Possible values: comma
%% separated list of [ctrl/alt/shift ] + key.
IgnoreKeys = ctrl+0x4f,ctrl+0x4c,ctrl+0x46,ctrl+0x50,0x74

%% 14 entries
%% This section configures the keyboard mappings. Set the
%% key codes in hex mode. For example : 0x70 for 'F1',
%% alt+0x71 for 'Alt F2', ctrl+0x41 for 'Control A', etc.
%% See the hex codes in the 'Keyboard Test' option.
[wfb\KeyboardMap]

%% Key Mapping for 'CapsLock' function.
%% Possible values: [ctrl/alt/shift] + key.
CapsLock =

%% Key mapping for 'Battery' button.
%% Possible values: [ctrl/alt/shift] + key.
CommandBarBatt =

%% Key mapping for navigation to homepage function.
%% Possible values: [ctrl/alt/shift] + key.
CommandBarHome =

%% Key mapping for navigation to next page function.
%% Possible values: [ctrl/alt/shift] + key.
CommandBarNext =
```

```
%% Key mapping for navigation to previous page.
%% Possible values: [ctrl/alt/shift] + key.
CommandBarPrev =

%% Key mapping for 'Refresh' button.
%% Possible values: [ctrl/alt/shift] + key.
CommandBarRefr =

%% Key mapping for 'RF Status' button.
%% Possible values: [ctrl/alt/shift] + key.
CommandBarRF =

%% Key mapping for showing and hiding the command bar.
%% Possible values: [ctrl/alt/shift] + key.
CommandBarShowHide =

%% Key mapping to enable or disable the touch-screen tap
%% functions on the command bar.
%% Possible values: [ctrl/alt/shift] + key.
CommandBarEnableDisableTap =

%% Key mapping to enable or disable the touch-screen tap
%% functions in the user frame window.
%% Possible values: [ctrl/alt/shift] + key.
FrameEnableDisableTap =

%% Key mapping to navigate to next control.
%% Possible values: [ctrl/alt/shift] + key.
%% The value "0" is used to disable ControlNext.
%% By default, DownKey scan code.
ControlNext =

%% Key mapping to navigate to previous control.
%% Possible values: [ctrl/alt/shift] + key. The value "0"
%% is used to disable ControlPrev. By default UpKey scan
%% code.
ControlPrev =

%% Activates the navigation by keyboard between controls
%% in a cyclic way. When "on", the last field is followed
%% by the first. Possible values: on/off.
CyclicNavigation = off

%% Key mapping to activate/deactivate the keyboard on
%% screen. Possible values: [ctrl/alt/shift] + key.
KeyboardActivateDeactivate = 0x74
```

```
%% 10 entries
%% This section configures the scanner mode options.
[wfb\Scanner]

%% Enables the scanner on each page that has inputs.
%% Possible values: on/off.
Enabled = off

%% Sends a <Tab> character through the keyboard interface
%% after each scan. Possible values: on/off.
AutoTab = off

%% Sends an <Enter> character through the keyboard
%% interface after each scan. Possible values: on/off.
AutoEnter = off

%% Scanner beep frequency in hertz (if the terminal
%% hardware doesn't allow wav files).
BeepFreq = 0

%% Scanner beep duration in milliseconds. 0 means no beep
%% (if the terminal hardware doesn't allow wav
%% files). Normal values: 0 or 200
BeepTime = 200

%% Sound file to play at successful barcode reading (if
%% the terminal hardware allows it).
WavFile =

%% Activates scanner only when focus is into a field.
%% Scanner deactivates at exit. Possible values: on/off.
InOutFieldActivate = on

%% Disable scanner after a successful reading. Possible
%% values: yes/no.
TurnOffScan = no

%% Key sequence to add as suffix to the scanned data.
%% Possible values: comma separated list of
%% "[ctrl/alt/shift] + key".
ScanTerminatorKeys =

%% Enables the scanner even when loading pages. Possible
%% values: on/off.
AlwaysActive = off

%% 5 entries
%% This section configures the display options.
[wfb\Screen]
```

```
%% Select icon or text for the image of the battery
%% button. Possible values: icon/text.
BatteryStatusButton = icon

%% Enable or disable the touch-screen tap functions on
%% the display area of the command bar. Possible values:
%% on/off.
DisableCBTouchScreen = off

%% Enable or disable the touch-screen tap functions on
%% the user frame window. Possible values: on/off.
DisableTouchScreen = off

%% Hide the command bar. Possible values: on/off.
HideCommandBar = off

%% Hide the scroll bar. Possible values: on/off.
HideScrollBars = off

%% Hides the "Wait Cursor". Possible values: on/off.
ShowWaitCursor = on

%% 1 entry
[wfb\Servers]

%% Connection type used. By WiFi LAN (network) or GPRS
%% WAN (ras).
ConnectionType = network

%% 7 entries
[wfb/TimeOut]

%% Time to wait for RF ready before send data.
RfWakeUp = 10

%% Displays a message while RF timeout has not elapsed
%% (see RfWakeUp). Possible values: on/off.
ShowTimeoutMsg = on

%% Title of the RF Timeout message box. The default title
%% is "Waiting for RF".
TimeoutMsgTitle = Waiting for RF...

%% Text of the RF Timeout message box.
TimeoutMsgText = Waiting for the connection to return

%% Height (in pixels) of the RF Timeout message box.
TimeoutMsgHeight =
%% Width (in pixels) of the RF Timeout message box.
```

```
TimeoutMsgWidth =

%% Waiting time from RF disconnection until the system
%% begins to search for a new active network interface.
RfPreWakeUp = 3

%% 2 entries
%% This section lists the applications that can be to
%% launched from the menu (in order to have access to
%% these applications, the option 'LaunchProcess' must be
%% on). It is possible to add up to 9 applications.
[wfb\Process]

%% Name shown in the menu.
Name00 = Calculator

%% File path for the application.
Proc00 = Windows\calc.exe
```

## User and Admin Options

There are two sections, one for configuring the User Menu, [wfb\UserOptions], and one for the Administrator Menu, [wfb\AdminOptions], which have the following keys:

- ActivateKeyboard,
- DisableNavBack,
- DisableNavForw,
- DisableNavRefr,
- KbdTest,
- LaunchProcess,
- LoadNewConfig,
- OptionsActivateContextMenu,
- OptionsFitToScreen,
- OptionsTextSize,
- SetHomePage,
- ToolbarKeyboard,
- ToolbarNavBack,
- ToolbarNavForw,
- ToolbarNavHome,
- ToolbarNavRefr,
- ToolbarRadFreq,
- Quit.

### **ActivateKeyboard**

This option shows the 'Activate Keyboard' option in the user mode menu.

### **DisableNavBack**

This option disables the 'Back' button in user mode.

### **DisableNavForw**

This option disables the 'Forward' button in user mode.

### **DisableNavRefr**

This option disables the 'Refresh' button in user mode.

### **KbdTest**

This option shows the 'Keyboard Test' option on the menu.

### **LaunchProcess**

This option shows the 'Launch Process' option on the menu.

**LoadNewConfig**

This option shows the 'Load New Configuration' option on the menu.

**OptionsActivateContextMenu**

This option shows the 'Activate Contextual Menu' option on the menu.

**Option FitToScreen**

This option shows the 'Fit To Screen' option on the menu.

**Option TextSize**

This option shows the 'Text Size' option on the menu.

**SetHomePage**

This option shows the 'Set Home Page' option on the menu.

**ToolbarKeyboard**

This option shows the icon to enable or disable the keyboard.

**ToolbarNavBack**

This option shows the 'Back' button on the toolbar.

**ToolbarNavForw**

This option shows the 'Forward' button on the toolbar.

**ToolbarNavHome**

This option shows the 'Home' button on the toolbar.

**ToolbarNavRefr**

This option shows the 'Refresh' button on the toolbar

**ToolbarRadFreq**

This option shows the 'RF Status' icon on the toolbar.

**Quit**

This option shows the 'Quit' option.

### The command bar:

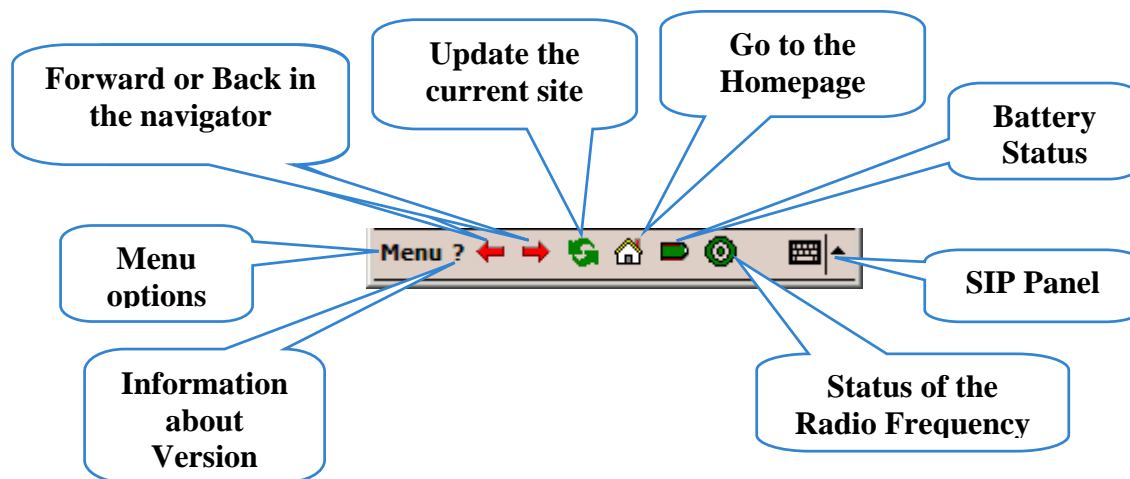

If any of these keys does not exist or contains a value different than “on” (no case sensitive), the menu, or the command bar, will not contain that option. Otherwise, that option will be activated on the menu or the command bar.

The following example shows a `_flexbrowser.cfg` file and afterwards there are the resulting screens for the application of that configuration.

```

%% FILE=_flexbrowser.cfg%%
%% V100

[wfb]
CacheSize                = 0
Homepage                 = wfb.html
HomepageConfirm          = off
HomepageConfirmText     =
Language                 = En
Mode                     = user
Password                 = 234
Traque                   = off
WorkingDir                = \windows
SaveSource                = off
ShowNewConfigDialog     = on

[wfb\AdminOptions]
ActivateKeyboard         = off
DisableNavBack           = off
DisableNavForw           = off
DisableNavRefr           = off
KbdTest                  = off
LaunchProcess            = off
LoadNewConfig            = on
OptionsActivateContextMenu = off
OptionsFitToScreen       = on
OptionsTextSize          = on
Quit                     = on
SetHomePage              = on
ToolbarNavBack           = on

```

ToolbarNavForw	= off
ToolbarNavHome	= on
ToolbarNavRefr	= on
ToolbarRadFreq	= on
ToolbarKeyboard	= off
[wfb\UserOptions]	
ActivateKeyboard	= off
DisableNavBack	= off
DisableNavForw	= off
DisableNavRefr	= off
KbdTest	= off
LaunchProcess	= off
LoadNewConfig	= off
OptionsActivateContextMenu	= off
OptionsFitToScreen	= on
OptionsTextSize	= on
Quit	= off
SetHomePage	= on
ToolbarNavBack	= off
ToolbarNavForw	= off
ToolbarNavHome	= off
ToolbarNavRefr	= off
ToolbarRadFreq	= on
ToolbarKeyboard	= off
[wfb\Emulation]	
SymbolPB	= on
iBrowse	= off
[wfb\Hp]	
Counter	= 2
Hp00	= <a href="http://ppc.softogo.com/fb/index.htm">http://ppc.softogo.com/fb/index.htm</a>
Hp01	= <a href="http://www.raisonnance.fr">http://www.raisonnance.fr</a>
[wfb\Keyboard]	
AllUpperDown	= none
SipOn	= on
IgnoreKeys	= ctrl+0x4f,ctrl+0x4c, ctrl+0x46,ctrl+0x50,0x74
[wfb\KeyboardMap]	
CapsLock	=
CommandBarBatt	=
CommandBarEnableDisableTap	=
CommandBarHome	=
CommandBarNext	=
CommandBarPrev	=
CommandBarRF	=
CommandBarRefr	=
CommandBarShowHide	=
ControlNext	=
ControlPrev	=
CyclicNavigation	= off

FrameEnableDisableTap	=
KeyboardActivateDeactivate	= 0x74
[wfb\Scanner]	
Enabled	= on
AutoEnter	= off
AutoTab	= on
BeepFreq	= 0
BeepTime	= 200
WavFile	=
InOutFieldActivate	= off
TurnOffScan	= no
ScanTerminatorKeys	=
AlwaysActive	= off
[wfb\Screen]	
BatteryStatusButton	= icon
DisableCBTouchScreen	= off
DisableTouchScreen	= off
HideCommandBar	= off
HideScrollBars	= off
ShowWaitCursor	= on
[wfb\Servers]	
ConnectionType	= network
[wfb\TimeOut]	
RfWakeUp	= 10
ShowTimeOutMsg	= on
TimeoutMsgTitle	= Waiting for RF...
TimeoutMsgText	= Waiting for connection to return
TimeoutMsgHeight	=
TimeoutMsgWidth	=
RfPreWakeUp	= 3
[wfb\Process]	
Name00	= Calculator
Proc00	= \Windows\Calc.exe

**Menu of the User Mode:**

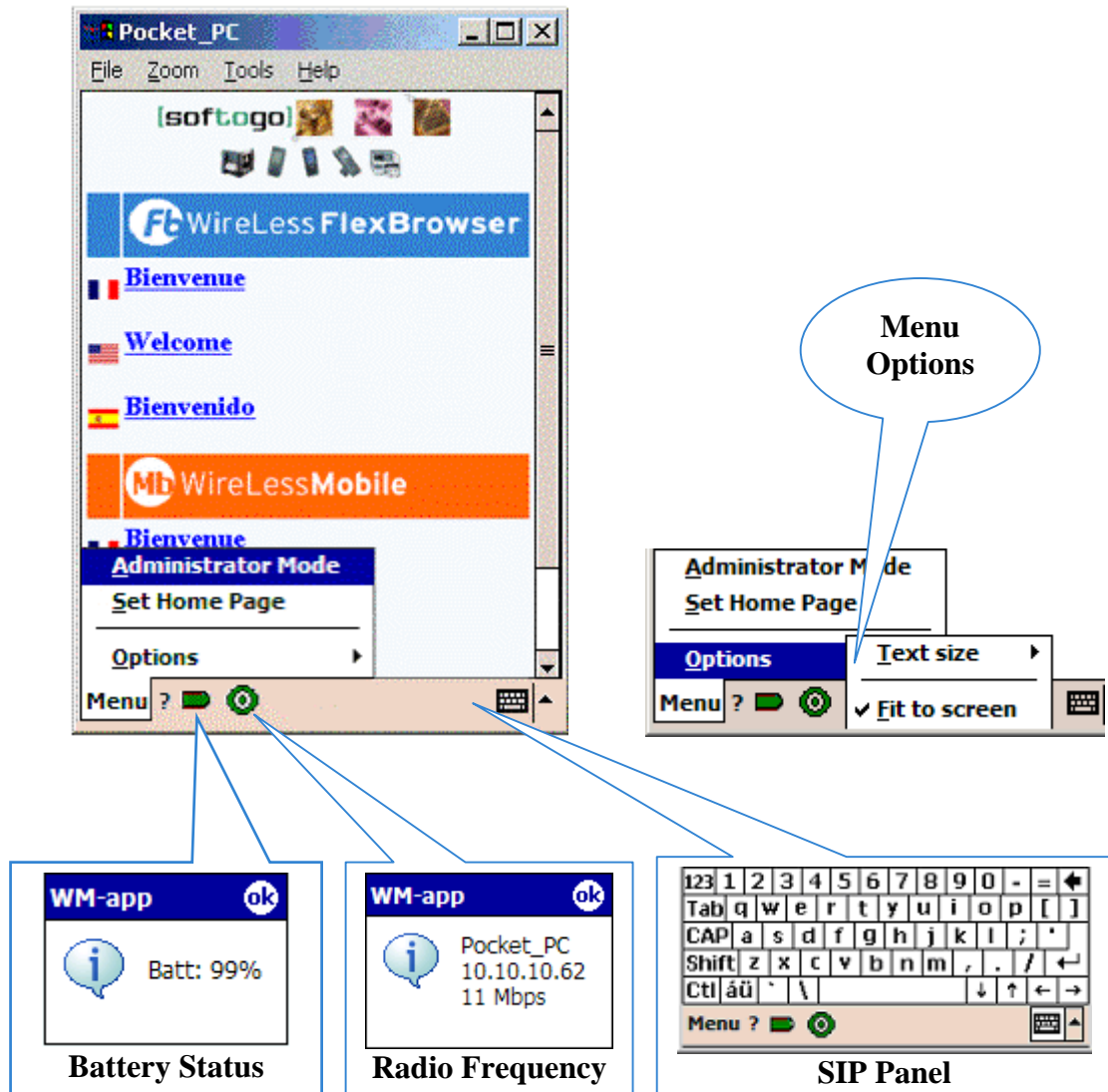

Menu of the Administrator mode:

